

# Quick User Guide

## LIBERTY™ 400

Maytronics Dolphin Cordless Robotic Pool Cleaner

### What's in the Box

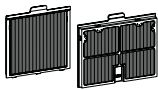

Extra filter panels

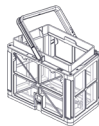

Filter basket



Grab hook



Clicker

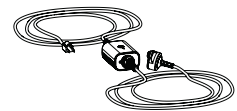

Charger

### First Time Use

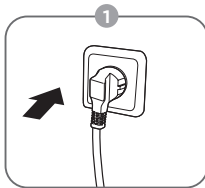

Plug the charger into the wall outlet

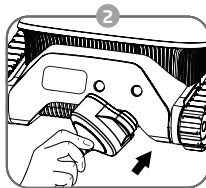

Connect the inductive charger to the robot



Peel-off the sticker

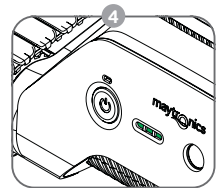

Charge the battery to 100% - 3 green bars

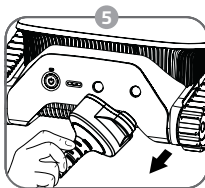

Unplug the inductive charger

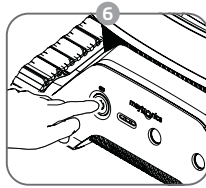

Press the power button

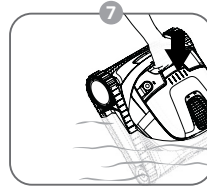

Put the robot in the pool. It will start cleaning within 30 seconds

8180170 Rev. 01

# Quick User Guide

## Features and Indications



### Cycle Selector

Use Cycle Selector to customize cleaning mode to "Floor only":

1. Press ON to activate until the LED lights up.
2. Press ON again for 3-6 seconds until the purple LED blinks 3 times. Place the robot in the pool, and within 30 sec, it will start working. After each cleaning cycle, the robot will return to default mode.



### ClickUp™

Easily take the robot out of the pool by shaking the Clicker in the water for 3 seconds when the robot has finished the cleaning cycle. The robot will climb up its nearest wall and wait a few seconds to be picked up.



### Eco Mode

Use Eco Mode to keep your pool floor clean for a week on one charge. The robot will automatically clean the pool floor for up to 30 min, three times a week, with 48 hours between cleaning cycles. Use Eco Mode to keep your pool floor clean for a week on one charge. The robot will automatically clean the pool floor for up to 30 min, three times a week, with 48 hours between cleaning cycles.

1. Press ON to activate until LED lights up.
2. After 3 seconds, you will see a purple LED flashing. Hold the button until you see the green LED flashing.
3. Place the robot in the pool, and within 30 sec, it will start working.

While in Eco Mode you can use the Clicker between cycles and at the end of the third cycle, however using the Clicker will cancel the eco mode.



### Temperature Warning

In case of temperature warning notification, place and charge the pool cleaner in a protected and shaded area, at a temperature range of 6°C - 35°C / 43°F - 95°F.



### Waterline Scrubbing

Scrubs then removes grime and oils that accumulate on the waterline.



### MyDolphin™ Plus Mobile App

Download the app, sign-up and follow the app instructions to pair with your robot. You can configure it with the MyDolphin™ Plus App while the robot is out of the water. When paired, the LED above the robot's power button will start flashing. Now you can schedule cleanups, set cleaning cycle type, and receive notifications when it is ready to be taken out of the pool.



### Error

In case of error notification, please refer to User Manual.



Scan for user manual



# Quick User Guide

## Removing the robot from the pool

**Grab hook** - Pull robot to waterline, then grab it with your hand to pull it out of the water.

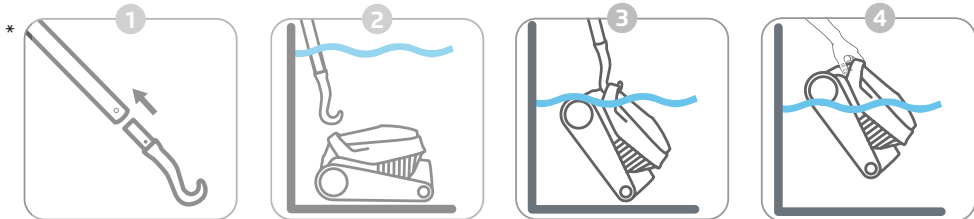

\* Standard pole, not included

### ClickUp™

After the cleaning cycle, shake the Clicker inside the water for over 3 seconds and the robot will climb its nearest wall. The robot needs to finish its cycle before it can be called up with the Clicker. In regular mode, the feature will be available for 6 days after the cleaning cycle ends.

Please note: When in **Eco Mode**, you can use the Clicker between cycles and at the end of the third cycle, however using the Clicker will cancel the **Eco Mode**.



### End of Cycle Pickup

In the last few minutes of its cleaning cycle, the robot will climb each wall and wait 20 seconds to be taken out. If you started the cycle with the app, you will get a push notification on your phone to let you know the robot is waiting. If it isn't picked up, it will wait on the floor near a wall. You can then use the Clicker or hook to take it out.

## Cleaning the Filter Basket

To prevent debris from hardening on the filter, we highly recommend quick-rinsing the filter immediately after removing the robot from the pool.

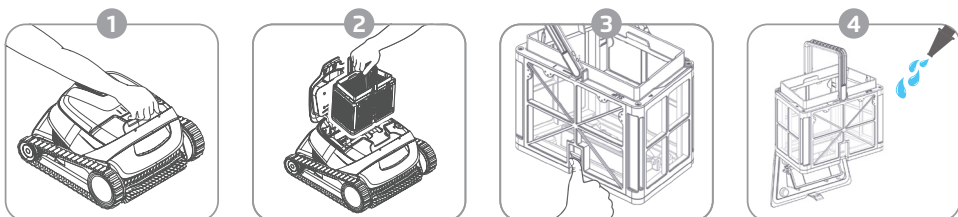

# Quick User Guide

## Charging Recommendations

- When the battery is low and all indicators are off - the cleaner is on standby mode. Connect to the charger to wake it up.
- Always charge the pool cleaner in a protected and shaded area at a temperature range of 6°C - 35°C / 43°F - 95°F, until you see 3 green bars in the battery indicator panel (up to 6 hours).
- The charger is rainproof, the robot can be charged when wet. However, do not put the charger in the water. It is not designed to be underwater.

## Off-Season Storage

Before off-season storage - Charge the battery to about 50% (2 green bars in the battery indicator panel).

Recommended storage temperature range: -10°C - 40°C / 14°F - 104°F.

Exceeding the maximum will likely damage the battery.

After off-season storage, charge the robot to its fullest.

## Info and recommendations

### Note

- Keep your fingers away from the impeller motor area to avoid injury.
- Any maintenance should be done only when the robot is off.
- Ensure that the electrical outlet is protected by a ground fault interrupter (GFI) or earth leakage interrupter.
- Do not put the charger in the pool.
- Do not enter the pool while the pool cleaner is working.
- In case of any physical damage to the pool cleaner or the charger, contact Customer Care for instructions.
- When removing the robot from the pool, set it on the edge to empty the water before lifting.
- Water temperature range: 6°C - 35°C / 43°F - 95°F
- Water depth range: 0.4m - 3m / 1.33ft - 9.8ft
- Motor protection: IP 68
- Charger protection: IP 54
- Chlorine - 4 ppm, Max.
- pH - 7.0-7.8
- NaCl - 5000 ppm, Max.
- Battery Lithium-ion | 5,000mAh



Scan for User Manual

For more information [www.maytronics.com.au](http://www.maytronics.com.au)

